

CW DIODE PUMP MODULE

(LMD-1064-C1000-4-45-1-D5H4-SF)

Lumispot

Features

- High power pumping ability
- Excellent beam and stability
- Continuous wave operation
- Compact and reliable design

Applications

- Spacing Telecommunications
- Environment R&D
- Micro-nano Processing
- Medical Equipment
- Atmospheric Research
- Image Processing

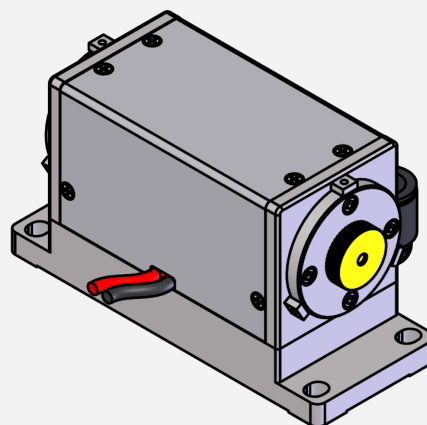

Optical parameter	Unit	Specification	Remarks
Pump Mean Power	W	≥ 600	–
Pump Center Wavelength	nm	806 ± 2	@30A, 25°C
Output Mean Power	W	≥ 200	450±5mm Cavity, 80%R OC
Single Bar Peak Power	W	≥ 50	–
Bar quantity	pcs	20	–
Crystal rod size	mm	$\varnothing 4 \times 95$	Nd_YAG
Luminous height	mm	45	–

Electrical parameter	Unit	Specification	Remarks
Operating mode	/	CW	–
Threshold current	A	≤ 7	–
Operating current	A	≤ 30	–
Operating voltage	V	≤ 40	–
Diode duty cycle	/	/	–
Diode pulse width	μs	/	–
Diode repetition rate	Hz	/	–

Another parameter	Unit	Specification	Remarks
Operating temperature	°C	25 ± 5	–
Storage temperature	°C	0~50	–
Volume flow of water	L/Min	10~12	–
Hydraulic pressure	Mpa	0.25~0.4	–

NOTE

1. Power use: Ensure that it is used at the rated voltage and power.
2. The laser must be installed reliably when working.
3. Follow the LumiSource Tech operating instruction manual.
4. For other questions, please contact us.
5. Electrostatic protection: the laser module in transport, storage, use must take appropriate anti-static measures.



We reserve all rights product specifications and descriptions are subject to change.

Products are delivered with a limited warranty only. Please contact our sales representatives for more info.

CW DIODE PUMP MODULE

(LMD-1064-C1000-4-45-1-D5H4-SF)

Lumispot

Features

- High power pumping ability
- Excellent beam and stability
- Continuous wave operation
- Compact and reliable design

Applications

- Spacing Telecommunications
- Environment R&D
- Micro-nano Processing
- Medical Equipment
- Atmospheric Research
- Image Processing

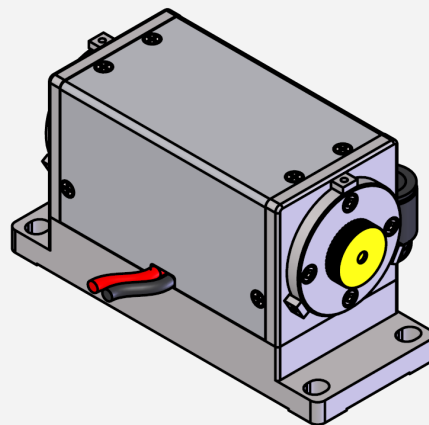

Structure Size

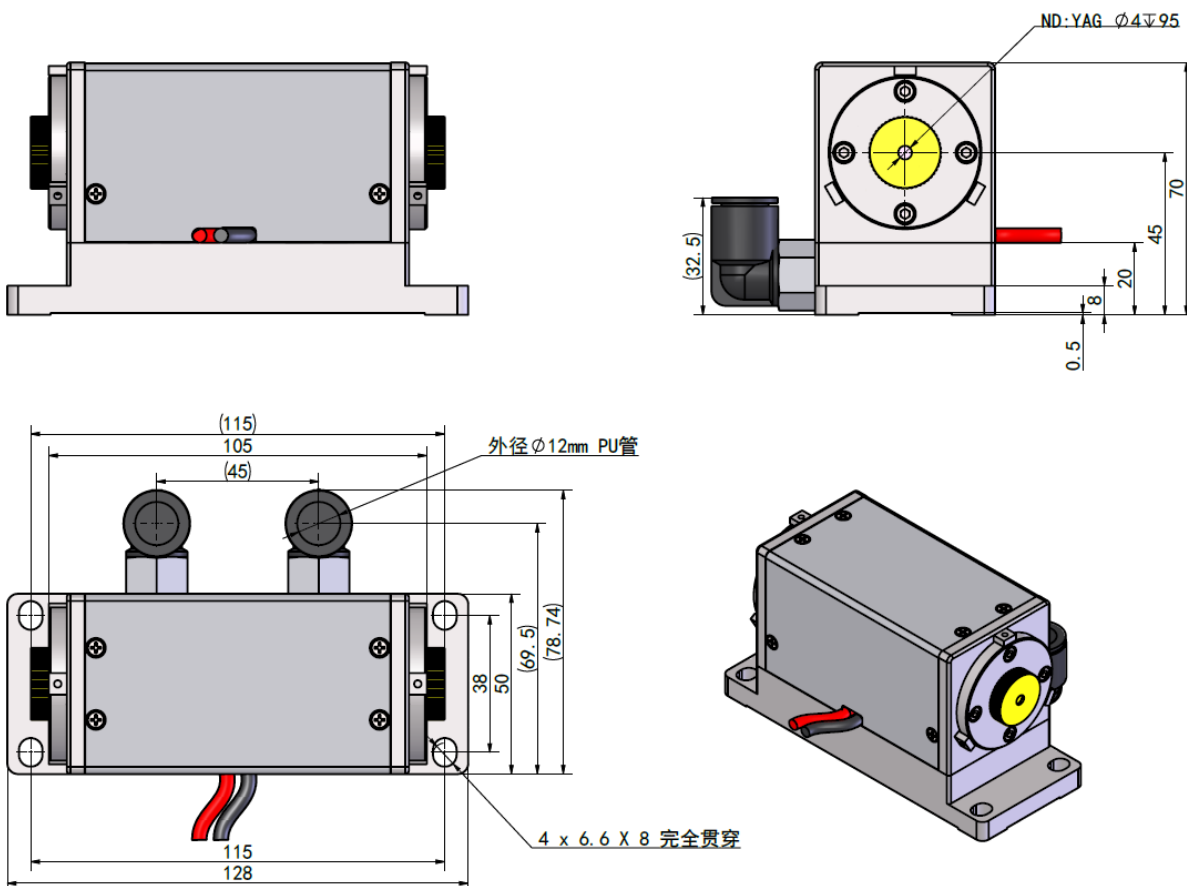

NOTE

1. Power use: Ensure that it is used at the rated voltage and power.
2. The laser must be installed reliably when working.
3. Follow the LumiSource Tech operating instruction manual.
4. For other questions, please contact us.
5. Electrostatic protection: the laser module in transport, storage, use must take appropriate anti-static measures.



We reserve all rights product specifications and descriptions are subject to change.

Products are delivered with a limited warranty only. Please contact our sales representatives for more info.